



RAPID CONSTRUCTION EXCEEDING EXPECTATIONS



PRE ENGINEERED STEEL BUILDINGS

www.epack.in

✦ SPEED

✦ STRENGTH

✦ SAFETY

COMPANY PROFILE



EPACK PREFAB is one of the leading turnkey solution providers for innovative and energy-efficient Pre-Engineered Buildings.

The principal activity of the organization comprises:

- Pre Engineered and Modular Prefabricated Buildings
- Insulated Sandwich Panel Manufacturing &
- Light Gauge Steel Framing

Since the inception of EPACK PREFAB in 1999 at a prime location in Greater Noida, EPACK PREFAB has been the one of the leading manufacturer of Prefabricated Structures in India producing more than 1,33,924 MT per annum and has covered over millions of sq. ft area worldwide.



2007

Projects Delivered in Last 3 years



35,470,629

Safe Man Hours

CERTIFICATIONS



EMPANELMENTS



END TO END PROJECT SOLUTION

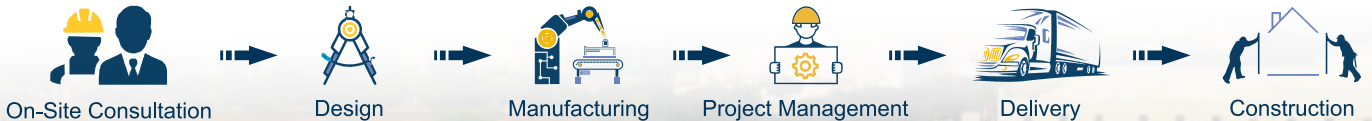

GROUP OVERVIEW

1999 – EPACK GROUP ESTABLISHMENT

EPACK Group was established at the turn of the century, by a family of entrepreneurs who brought together the best of resources in manpower and technology to setup an EPS (Expanded Polystyrene Packaging) manufacturing facility in Greater Noida, on the outskirts of Delhi. This initiative, which proved to be a huge success, was an outcome of years of effort, juggling work and family commitments. Ever since, our entrepreneurial streak kept growing and soon enough we diversified business into two more verticals – Consumer Durables and Pre-Engineered Buildings Manufacturing.

PROMOTERS



BAJRANG BOTHRA
Promoter & Chairman



L P BOTHRA
Promoter



SANJAY SINGHANIA
Managing Director



AJAY DD SINGHANIA
Non-Executive Director



NIKHEL BOTHRA
Executive Director



BUSINESS VERTICALS

As of today, EPACK Group has three major business verticals:



Pre-engineered /
Prefabricated buildings &
Infrastructure projects



Consumer Durables
Manufacturing - Air
Conditioners, Induction
Cooktops, Water dispensers,
Juicer Mixer Grinders, etc.



EPS (Expanded Polystyrene)
Packaging Manufacturing

WHERE DO WE STAND

As of today, EPACK Group is

- One of the leading processor of EPS packaging in the country.
- The Second largest ODM (Original Design Manufacturer) of Room Air Conditioner in the country.
- Leading & Fastest growing Pre Engineered Buildings manufacturing Company” in India.

15 fully operational manufacturing plants spread across India. Out of this

- 7 Manufacturing Plants – for Consumer Durables products
- 2 Manufacturing Plants – for processing of EPS packaging
- 5 Manufacturing Plants – for Pre Engineered/Prefabricated Structures and Insulated Sandwich Panels
- 1 Manufacturing Plant - for Petrochemicals

Our Philosophy

The philosophy of EPACK Group is to remain among the TOP 3 players in all its business segments.

EPACK GROUP COMPANIES



EPACK JOURNEY

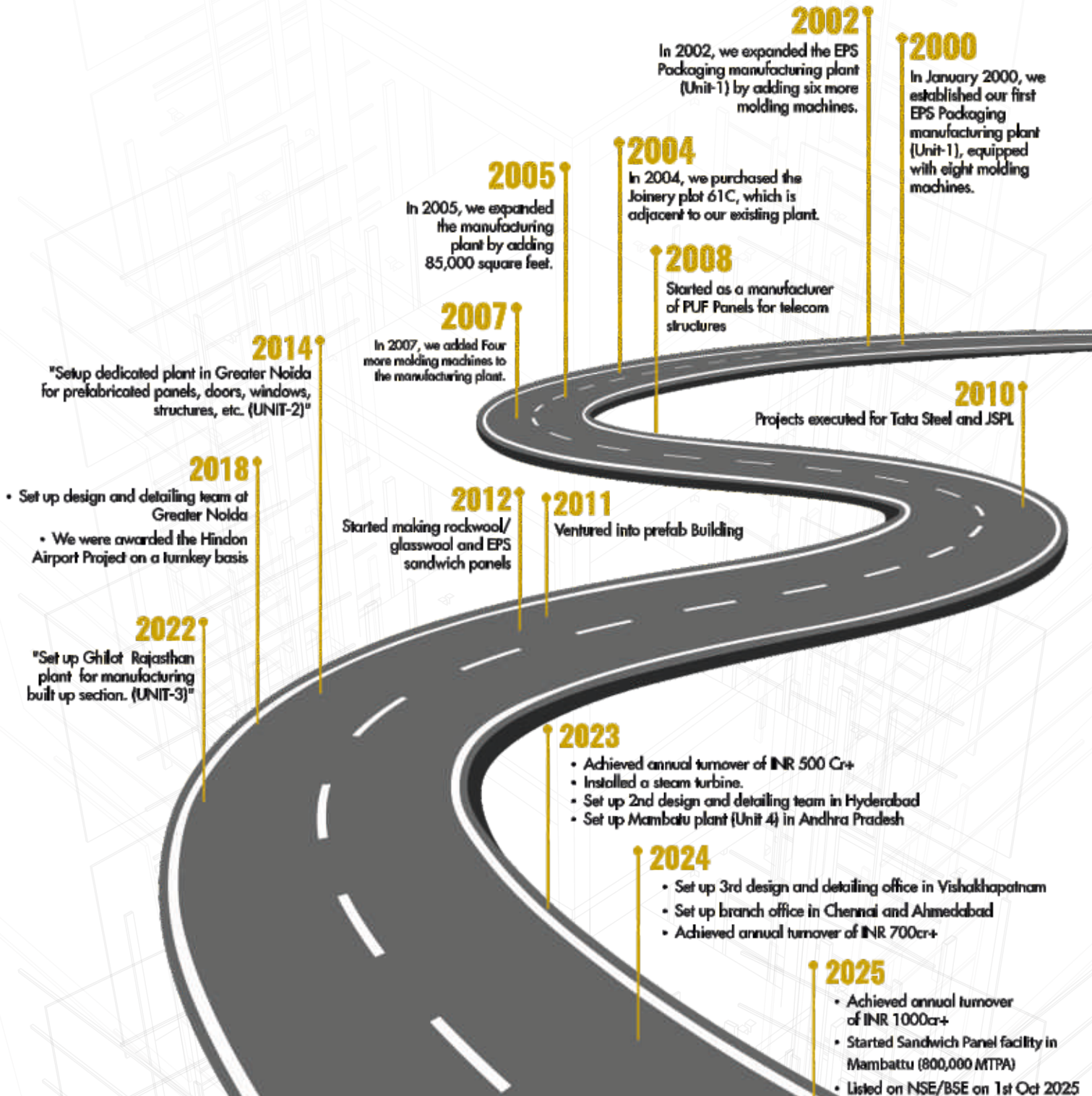

WHAT WE HAVE ACHIEVED SO FAR

Best HSE Award
IIN- Platinum Awards 2025

CIA World
Best Pre- Engineered Building Company Award 2024

Silicon India
Top 10 Most Promising Modular Construction Companies Award 2024

Golden Book Of World Record
Fastest PEB Factory Construction

CSCMP
Manufacturing Excellence Award 2021

CPWD
Fastest Construction in J&K Award 2021

52nd National
Safety Week Safety Award 2023



EPIC MEDIA

Presents

CIA
WORLD

10th

Infra Awards



PROVEN LEADERS IN
RAPID CONSTRUCTION



EPACK PREFAB CREATES
WORLD RECORD

1,51,000 Sqft PEB Factory Building Erection in 150 Hours



Award presented to

Sanjay Singhania (MD & CEO) & Nikhel Bothra (Executive Director)

FASTEST CONSTRUCTION TIMELINE



Scan to Watch the Fastest
Factory Building construction



0 hr



0-24 hr



24-48 hr



48-72 hr



72-120 hr



150 hr

All India Presence with STATE-OF-THE-ART MANUFACTURING FACILITY

PEB Plant Capacity: 38,262 MT
Panel Capacity: 510,000 Sqm
Land Area: 258,808 sqft.
Built up Area: 201,876 sqft.



Unit 1 & 2
Greater Noida, Uttar Pradesh

PEB Plant Capacity: 27,550 MT
Land Area: 215,278 sqft.
Built up Area: 145,000 sqft.



Unit 3
Chiloth, Rajasthan

PEB Plant Capacity: 68,112 MT
Land Area: 886,946 sqft.
Built up Area: 487,820 sqft.



Unit 4
Mumbatu(Tirupati), Andhra Pradesh

Panel Capacity: 8,00,000 Sqm
Land Area: 1,33,995 sqft.



Unit 4 A
Mumbatu(Tirupati), Andhra Pradesh

Production Capacity
1,33,924 MT / annum PEB
13,10,000 sqm / annum Panel

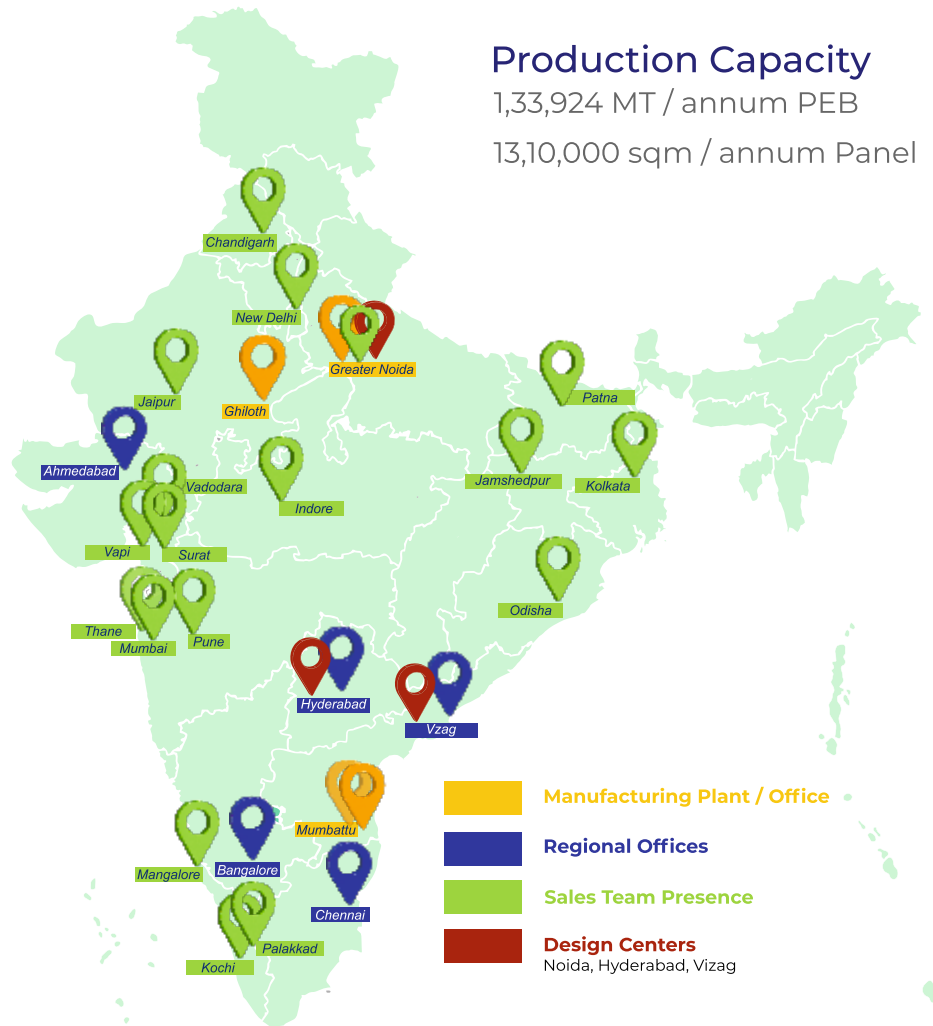

REGIONAL PRESENCE

Hyderabad, Vizag, Chennai, Mangalore
Kochi, Palakkad, New Delhi, Noida, Jaipur
Mumbai, Thane, Pune, Ahmedabad, Vadodara
Vapi, Surat, Indore, Kolkata, Bangalore
Jamshedpur, Patna, Coimbatore, Chandigarh
Guwahati, Bhubaneswar



Scan for
360 Plant View





CONTINUOUS H-BEAM WELDING MACHINE



CNC PLASMA CUTTING MACHINE



SHOT BLASTING MACHINE



SHEARING MACHINE



CNC PUNCHING MACHINE



POWER PRESS MACHINE



ROOF PROFILE MACHINE



CONTINUOUS SANDWICH PANEL MACHINE



CANON FOAMING MACHINE



LGSF MACHINE



C / Z PURLIN MACHINE



BENDING MACHINE



DECOILING MACHINE



DOUBLE BELT MACHINE



ROLL FORMING MACHINE



PANEL COOLING MACHINE



AUTO STACKING MACHINE



AUTOMATIC PANEL WRAPPING MACHINE

CONSTRUCTION TECHNOLOGIES WE OFFER

PRE ENGINEERED BUILDINGS

- Warehouses
- Factory Sheds / Industrial Buildings
- Multi-storey Buildings
- Commercial Buildings etc...

MODULAR PREFABRICATED BUILDINGS

- Accommodations
- Schools/Hospitals
- Construction Site Offices
- Relief Camps etc...

LGSF BUILDINGS

- High Rise Buildings
- Transit Camps
- Office Buildings
- Villa / Cottages etc...

INSULATED SANDWICH PANELS

- PUF Insulated Panels
- EPS Insulated Panels
- ROCKWOOL Insulated Panels
- GLASSWOOL Insulated Panels

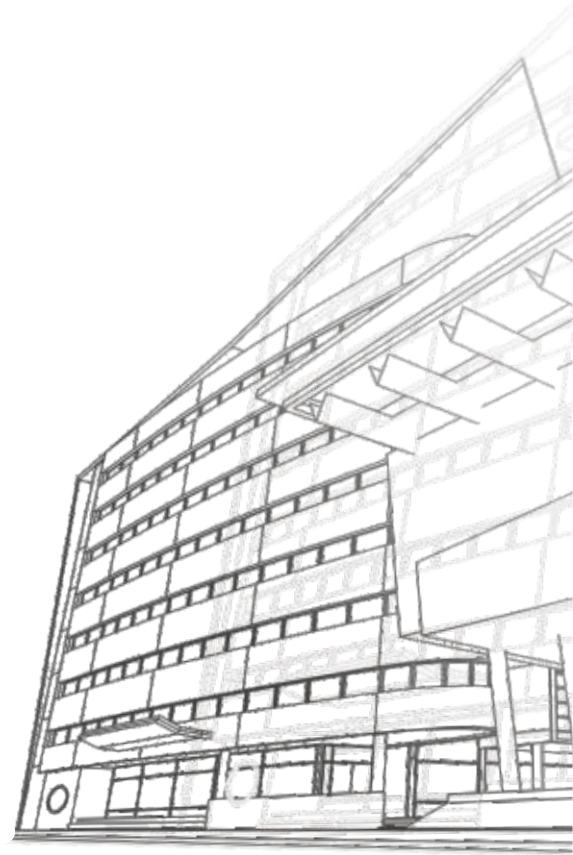

Structures

Hot Rolled & Cold Formed Steels

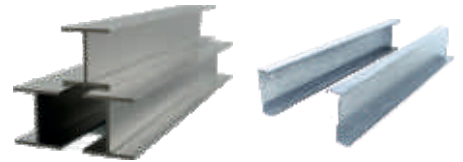

Cold Formed Structures



Hollow Sections



SECTORS WE CATER

INDUSTRIAL

- Warehouses
- Industrial Sheds
- Factory Buildings
- Cold Storage Buildings
- Clean Rooms
- Poultry Sheds
- Industrial Enclosures

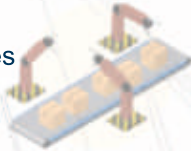

INFRASTRUCTURE

- Airport Terminal Buildings
- Aircraft Hangars
- Metro Stations
- Railway Sheds
- Foot Over Bridges
- Shopping Complex
- Petrol Pump Stations



INSTITUTIONAL

- School Buildings
- Hospitals
- Hostel Buildings
- Laboratories
- Exhibition Halls
- Office Buildings



CONSTRUCTION

- Site Offices
- Staff Accommodations
- Canteen Buildings
- Toilet Blocks
- Guard Rooms



SPORTS & LEISURE

- Stadiums
- Sports Complexes
- Auditoriums
- Gymnasiums



SPECIAL BUILDINGS

- Control Rooms
- Kiosks
- Noise Proof Enclosures
- Multilevel Car Parkings
- GIS Buildings

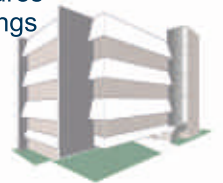

Roof & Wall

Insulated Sandwich Panels

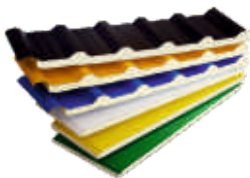

Light Gauge Steel Framing



Single Skin Sheet



Standing Seam Roof

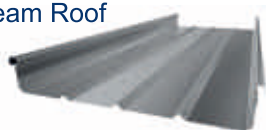

Insulation

PUR/PIR
EPS
Rockwool
Glasswool



Bubble / XLPE



Flooring

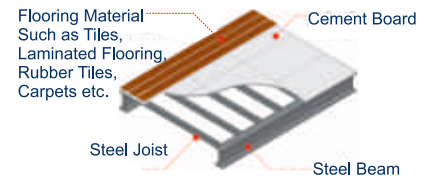
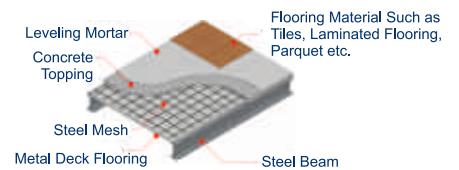



GRIHA CERTIFIED

EPACK ROOF & WALL ENVELOPE SOLUTIONS (INSULATED SANDWICH PANELS)

EPACK PREFAB manufactures high-performance Insulated Continuous Line Sandwich Panels, designed for superior thermal efficiency, fire safety, and durability. Available with PUR/PIR, EPS, Rockwool, and Glasswool cores, they offer optimal insulation and energy savings for industrial, commercial, and residential applications like cold storage and modular buildings. Our panels are eco-friendly, CFC and HCFC-free, with zero ODP ratings, and made from recyclable materials and supporting green building certifications.

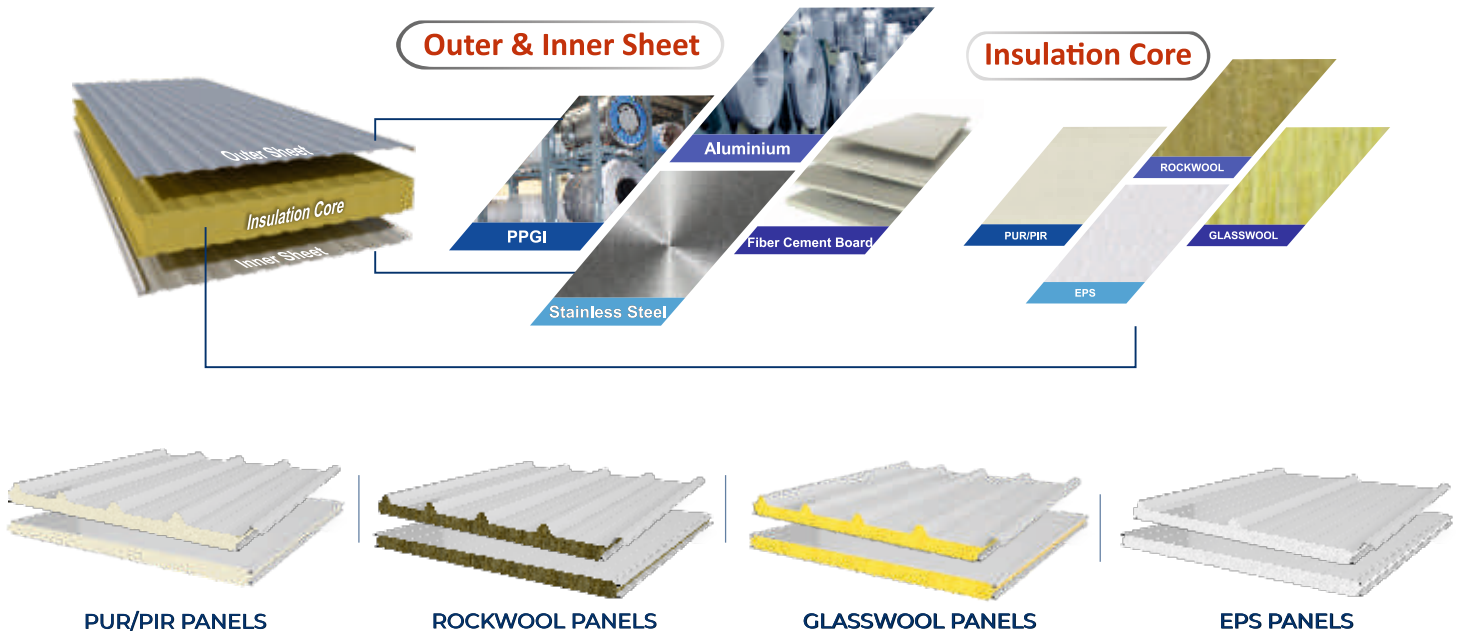

PANEL TEST REPORTS



PANEL NAME	TEST TYPE	TEST STANDARD	TEST RESULTS
Rock Wool Panel	Fire Resistance Test (2 HRS)	BS 476-20:1987 & BS 476-22:1987	Integrity: 120 minutes, Insulation: 120 minutes
PUF Panel	Thermal Conductivity Test	ASTM C518-2016	Thermal Conductivity: 0.01985 W/mK (Requirement: max. 0.023 W/mK)
PUF Panel	Water Vapor Transmission Rate	IS 11239: 2014 (Part-4)	Mean: 1.21 ng/pa.s.m (Requirement: 5.5 max for PUR-1)
PUF Panel	Compressive Strength (10% Core deformation)	ASTM D1621-2016 (RA-2023)	Mean: 137.3 kN/m ² (Requirement: 115 min for PUR-1)
PUF Panel	Apparent Density Test	ASTM D1622-20	Mean: 40.2 kg/m ³
PUF Panel	Tensile Strength Test	ASTM D1623-17 (Reapproved 2023)	Mean: 386.8 kPa
PUF Panel	Closed Cell Content	IS:11239 (Part5)- 2009 (Method- 2)	Mean: 95.4% (Requirement: 85% min)
PUF Panel	Dimensional Stability	ASTM D2126-2015	At 70°C for 24 hours: (-) 0.88% (Requirement: ±2%)
PUF Panel	Water Absorption Test	IS 11239: 1988 (Part-9)	Mean: 0.55% by volume
PUF Panel	Climbing Drum Peel Test	ASTM D1781-1998 (2004)	Average: 0.71 N/mm
PUF Panel	Adhesion Strength	ASTM C297-2016	Mean: 233 kPa
PUF Panel	Flexural Strength	IS 11239-10,1985	Mean: 576 kPa
PUF Panel	CFCs & HCFCs Analysis	Not specified	All 37 CFC and HCFC compounds: Not Detected (MQL: 1 mg/kg)
PUF Panel	Fire Ignitability Test	BS 476 Part 5:1979	Index of Performance: P, constant mass at a temperature of 23 ± 2°C and a relative humidity of 50 ± 5%
PUF Panel	Horizontal Burning Characteristics	IS:11239(Part12)-1988	Mean Burning Extent: 12mm

EPACK SANDWICH PANEL PROFILES

EPACK SINGLE GROOVE WALL PANEL



Types of Ribbing	Standard Rib, Micro Rib	
Types of Panels	PIR/PUR	Rockwool Panels
Thickness	30/40/50/60mm	50mm
Width *	1150mm	1150mm

* ALSO AVAILABLE IN WIDTH 1000MM IF ORDER QUANTITY IS LARGE

EPACK DOUBLE GROOVE WALL PANEL



Types of Ribbing	Standard Rib, Micro Rib	
Types of Panels	PIR/PUR	Rockwool Panels
Thickness	60/80/100/120/150mm	80/100mm
Width*	1100mm	1100mm

* ALSO AVAILABLE IN WIDTH 950MM IF ORDER QUANTITY IS LARGE

EPACK HIDDEN SCREW WALL PANEL



Types of Ribbing	Standard Rib, Micro Rib	
Types of Panels	PIR/PUR	Rockwool Panels
Thickness	50/60mm	50/60mm
Width *	1050mm	1050mm

* ALSO AVAILABLE IN WIDTH 900MM IF ORDER QUANTITY IS LARGE

EPACK ROOF PANEL



Types of Ribbing	Standard Rib, Micro Rib	
Types of Panels	PIR/PUR	Rockwool Panels
Thickness	30/50/60/80mm	50/80mm
Width	1100mm	1100mm

EPACK CAMLOCK WALL PANEL



Types of Panels	PUF Panel
Thickness	40/50/60/80/100/120/150mm
Width	1200mm

EPACK OTHER PANELS

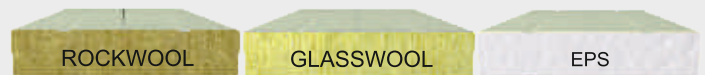

Types of Panels	Thickness	Width
Discontinuous PUF Roof	30/40/50/60/80/100/120mm	993mm
Rockwool	50/60/80/100/120mm	1170mm
Glasswool	50/60/80/100mm	1170mm
EPS	40/50/60/80/100/120/150mm	1170mm

TECHNICAL DATA SHEET

PUR/PIR PANEL

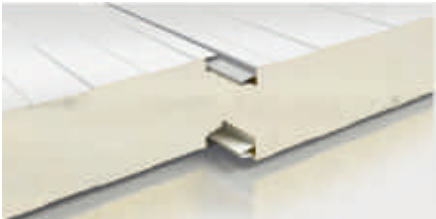

Thickness (MM)	PUR U-value (W/m ² .K)	PIR U-value (W/m ² .K)
40.0	0.5	0.46
50.0	0.41	0.37
60.0	0.34	0.32
80.0	0.26	0.24
100.0	0.21	0.19
120.0	0.18	0.16
150.0	0.14	0.13

Properties	Polyurethane Foam(PUR)	Polyisocyanurate Foam (PIR)
Insulation	CFC & HCFC Free RIGID Polyurethane FOAM (PUF) As Per IS: 12436 Standard	CFC & HCFC Free RIGID Polyisocyanurate FOAM (PIR) As Per IS: 12436 Standard
Foam Overall Density	40 ± 2 kg/m ³	40 ± 2 kg/m ³
Foam Thermal Conductivity (K-Value) at 10°C mean Temp	0.023 w/m K	0.023 w/m k
Compressive Strength @ 10% deformation	2.10 kg/cm ²	2.10 kg/cm ²
Tensile Strength	2.5 kg/cm ²	2.5 kg/cm ²
Flexural/ Bending Strength	3.0 kg/cm ²	3.0 Kg/cm ²
Shear Strength	2.5 Kg/cm ²	2.5 Kg/cm ²
Closed Cell Contents	90-95%	90-95%
Horizontal Burning Characteristics	125 mm (Extent of Burn)= Max, Fire Retardant, Self Extinguishing Quality Foam	25 mm (Extent of Burn) - Max, Fire Rated
Water absorption	0.2% volume at 100% RH - Max	0.2% volume at 100% RH - Max
Water Vapour Permeability	0.12 ng/pasm at 88% RH & 38°C - Max	0.12 ng/pasm at 88% RH & 38°C - Max
Dimensional Stability at -25°C Cold Temp.	±2%	±2%
Dimensional Stability at +70°C Hot Temp.	±2%	±2%

ROCKWOOL PANEL

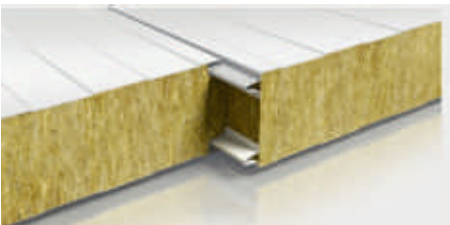

Thickness (MM)	Rockwool U- value (W/m ² .K)
40.0	0.8
50.0	0.66
60.0	0.56
80.0	0.43
100.0	0.35
120.0	0.29
150.0	0.24

Properties	Rockwool Panel
Insulation	Non-Combustible Rockwool Core with PPGS/PPGL Fascia
Overall Density	100±15 Kg/m ³
Thermal Conductivity (K-Value) at 10°C mean Temp	0.04 W/m K
Compressive Strength @ 10% deformation	0.50985 Kg/cm ²
Tensile Strength	0.3 Kg/cm ² (Estimated)
Flexural/ Bending Strength	0.7647 Kg/cm ²
Shear Strength	0.15 Kg/cm ² (estimated)
Closed Cell Contents	0% (Open-Fiber Structure)
Horizontal Burning Characteristics	Highly Fire Resistant (Non-Combustible)
Water absorption	Less than 1%
Water Vapour Permeability	150 ng/pasm at 88% RH & 38°C (Estimated)
Dimensional Stability at -25°C Cold Temp.	±1%
Dimensional Stability at +70°C Hot Temp.	±1%

EPACK Roof Sheeting & Wall Cladding

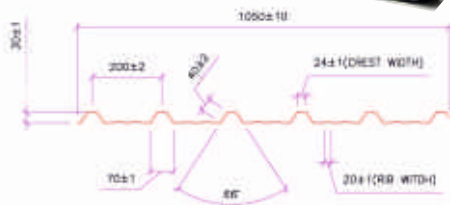

EPACK Decking Sheet

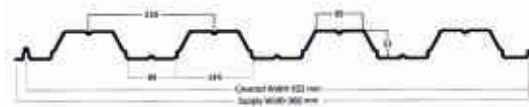

EPACK In Situ Sandwich Roofing System

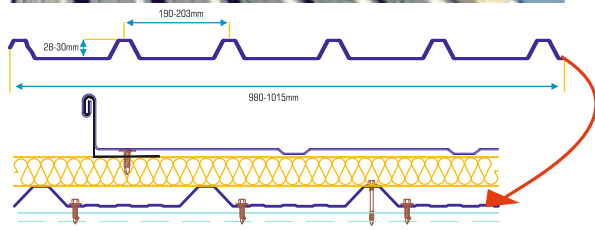

EPACK 360 Standing Seam Roofing System

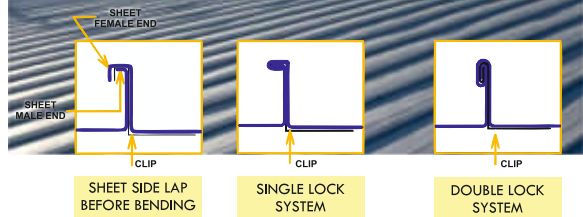
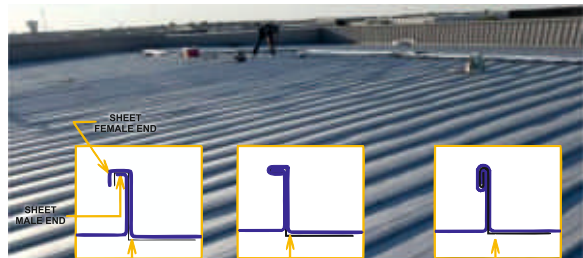

Direction of Sheet Laying

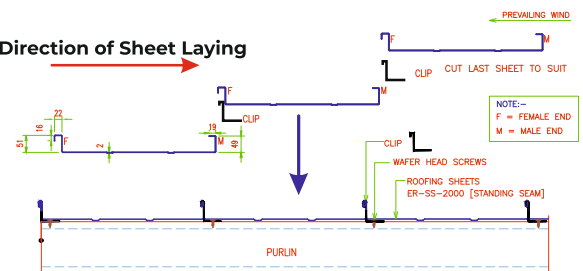

WHAT MAKES EPACK A GREAT PARTNER

THE ARCHITECTS OF INNOVATION

- Cutting-edge Design Software
- Well-qualified And Experienced Designers
- Dedicated Designers for Each Project:
- PAN India Presence of Designers
- Dedicated Designers for Each Sales Team

DELIVERING QUALITY ON TIME

- One of the Largest Project Team in India.
- Dedicated Site Engineer, Project Manager And Safety Engineer for Each Project.
- Stringent 180 Steps Quality Check Before Material Dispatch.
- Hourly Safety Monitoring of Each Project From Head Office.

ETABS



STAAD.Pro
CONNECT Edition

Tekla
Structures

A AUTODESK
AUTOCAD

m/s

VERTEX
SYSTEMS





KEEPING YOU INFORMED

- State-of-the-art ERP and CRM system to provide regular updates about orders and projects.
- Strong digital system and automated reports to kept you informed at every step of the project, from design to execution.
- Dedicated SCO's and CRO's assigned to oversee each project.

CONVENIENCE AND EFFICIENCY

- All solutions available under one roof, from design and manufacturing to installation and after-sales support.
- Customized solutions to meet your specific needs and requirements.
- Expert team committed to delivering high-quality services that meet your expectations.



PROJECTS

At EPACK PREFAB, we take pride in our expertise and experience in providing Pre-Engineered Steel Building Turnkey Solutions to clients across the globe. Since our inception, we have successfully delivered millions of sqft. of pre-engineered buildings, ranging from warehouse buildings to Airport Terminal Buildings.

Our success is a result of our in-house team of experienced professionals who work closely with clients to ensure that every project is executed rapidly and to the highest standards. Our design team uses cutting-edge software and technologies to create custom designs that meet the unique needs and specifications of each client.





**EPACK
PREFAB**

RAPID CONSTRUCTION EXCEEDING EXPECTATIONS

- Cement
- FMCG & Beverages
- Cold Storage & Refrigeration
- Steel Processing
- Plastic & Packaging
- Warehouse & E-Logistics
- Automobile
- Chemicals & Fertilizers
- EPC Contractor
- Electrical & Electronics
- Power & Renewable Energy
- Pharma
- Institutional & Infrastructure
- Building Materials

JETTYRE

TCI LOGISTICS & SUPPLY CHAIN

Shankar Freight Logistics (P) Ltd.

Hero

ESR

AWSL

AVG

ASK AUTOMOTIVE (PI) LTD.

NARAYANI MOTORS PVT LTD

APML

FWS

DRS

amazon

Dhariwal

MENETA

BALDOTA

MAHIMA GROUP Committed to Excellence

zepto

SNOWMAN

MAJESTIC AUTO LIMITED

HONDA

SAFEXPRESS

TRANSAFE TRANSAFE SERVICES LIMITED

D.R. Auto Industries

NDR

ascendas PROTECTANCE

VESUVIUS

STAR 6587

PLASHOTEC

ASHOK LEYLAND

Flipkart

all cargo

Dalmia Bharat Limited

MCS

Valeo

SANDHAR Growth, Innovation, Better Life

ECR INDIAN

UltraTech CEMENTS

YANKIT

PRISM JOHNSON LIMITED

VARUNA

apg trust at every point

JSW Cement

KHIVRAJ

NECLITE

SEVADEURA

CAMPA

ARL

UDAAK Building the Future

LEAR CORPORATION

CELO

VOLTAS

Inficold

Sai Cold Storage

TATA STEEL

JSW Steel

JINDAL STEEL & POWER

JSL STEEL CITY

VECTUS

GENERAL GROUP

ADITYA BIRLA UTKAL ALUMINA

PCP

AXIVA

KEC CONSTRUCTION LTD.

NBCC A Navamra CPSE

NCC TATA TATA PROJECTS

L&T Construction Heavy Civil Infrastructure

SCC Building Better India

Iron International Limited Turkey International Construction Group

GAR

Pidilite

INDIA GLICOLS LIMITED

B.P. CONSTRUCTION

ROHAN ROHAN INDUSTRIES LTD.

Huake Group Clean Room

TOSHIBA

HAVELLS

JKM

TAKENAKA

JAIPRAKASH ASSOCIATES LIMITED

wipro

SMC

HYOSUNG H&S PVT. LTD.

HFCL

BLUE STAR

Sterlite Power

Haier

SIEMENS

adani Renewables

ABB

ReNew

HUSK

AVAADA

SONIC BIOCHEM

FERRING

HETERO HEALTHCARE

CIPRO INDIA

POLYMED

Aster Public Health

SAI

PDIL

SAI

Trishala

JAQUAR

CENTURYPLY

FACTORIES & WORKSHOPS



Scan to Watch Project Videos



Area: 13.8 Lakh Sqft.



Belgaum, Karnataka



Area: 7.29 Lakh Sqft.

Kadapa, Andhra Pradesh



Area: 6.52 Lakh Sqft.

Gwalior, Madhya Pradesh



Area: 4.95 Lakh Sqft.

Bhiwadi, Rajasthan



Area: 4.25 Lakh Sqft.

Bhiwadi, Rajasthan



Area: 4.17 Lakh Sqft.

Chittorgarh, Rajasthan



Area: 4.07 Lakh Sqft.

Greater Noida, Uttar Pradesh



Area: 3.71 Lakh Sqft.

Jaipur, Rajasthan



Area: 3.12 Lakh Sqft.

Guwahati, Assam

Area: 3.08 Lakh Sqft.



Greater Noida, Uttar Pradesh

Area: 2.85 Lakh Sqft.



Bhiwadi, Rajasthan

Area: 2.23 Lakh Sqft.



Bhilwada, Rajasthan

Area: 1.72 Lakh Sqft.



Jaipur, Rajasthan

Area: 1.71 Lakh Sqft.



Ghiloth, Rajasthan

Area: 1.52 Lakh sqft.



Maddipadu, Andhra Pradesh



Area: 1.53 Lakh Sqft.

Star Cement
Lumshnong, Meghalaya



Area: 1.54 Lakh Sqft.

Chiloth, Rajasthan



Area: 1.27 Lakh Sqft.

Pali, Rajasthan



Area: 1.24 Lakh Sqft.

Bhiwadi, Rajasthan



Area: 1.3 Lakh Sqft.

Sikandrabad, Uttar Pradesh



Area: 0.83 Lakh Sqft.

Bhiwadi, Rajasthan



Area: 0.80 Lakh Sqft.

Ghiloth, Rajasthan



Crane Capacity: 200 MT

Sonipat, Haryana



Area: 2.16 Lakh Sqft.

Greater Noida, Uttar Pradesh



Area: 1.1 Lakh Sqft.

Indore, Madhya Pradesh

SOLAR INFRASTRUCTURE



WAREHOUSES



Area: 9.41 Lakh Sqft.

Palwal, Haryana



Area: 7.2 Lakh Sqft.

Kolkata, West Bengal



Area: 4.48 Lakh Sqft.

Visakhapatnam, Andhra Pradesh



Area: 4.08 Lakh Sqft.

Sikandrabad, Uttar Pradesh



Area: 4.01 Lakh Sqft.

Greater Noida, Uttar Pradesh



Area: 3.36 Lakh Sqft.

Gorakhpur, Uttar Pradesh



Area: 2.69 Lakh Sqft.

Sonipat, Haryana



Area: 2.32 Lakh Sqft.

Greater Noida, Uttar Pradesh



Area: 2.15 Lakh Sqft.

Greater Noida, Uttar Pradesh







Area: 1.71 Lakh Sqft.

Neemrana, Rajasthan



Area: 0.64 Lakh Sqft.

Darrang, Assam



Area: 0.60 Lakh Sqft.

Dalmia Cement
Lanka, Assam





Area: ~3 Lakh Sqft.

Thrissur, Kerala



Area: 2 Lakh Sqft.

Kochi, Kerala



Area: 60,000 Sqft.

Kanchipuram, Tamil Nadu



Chennai



Jaipur, Rajasthan



Area: 1.16 Lakh Sqft.

Farukhnagar, Haryana

OFFICES



Scan to Watch Project Videos



Area: 6.45 Lakh Sqft.



Noida, Uttar Pradesh



Area: 0.15 Lakh Sqft.

Noida, Uttar Pradesh

MULTISTOREY BUILDINGS



Scan to Watch Project Videos



G+6 School Building

Greater Noida, U.P



G+5 Commercial Building

New Delhi

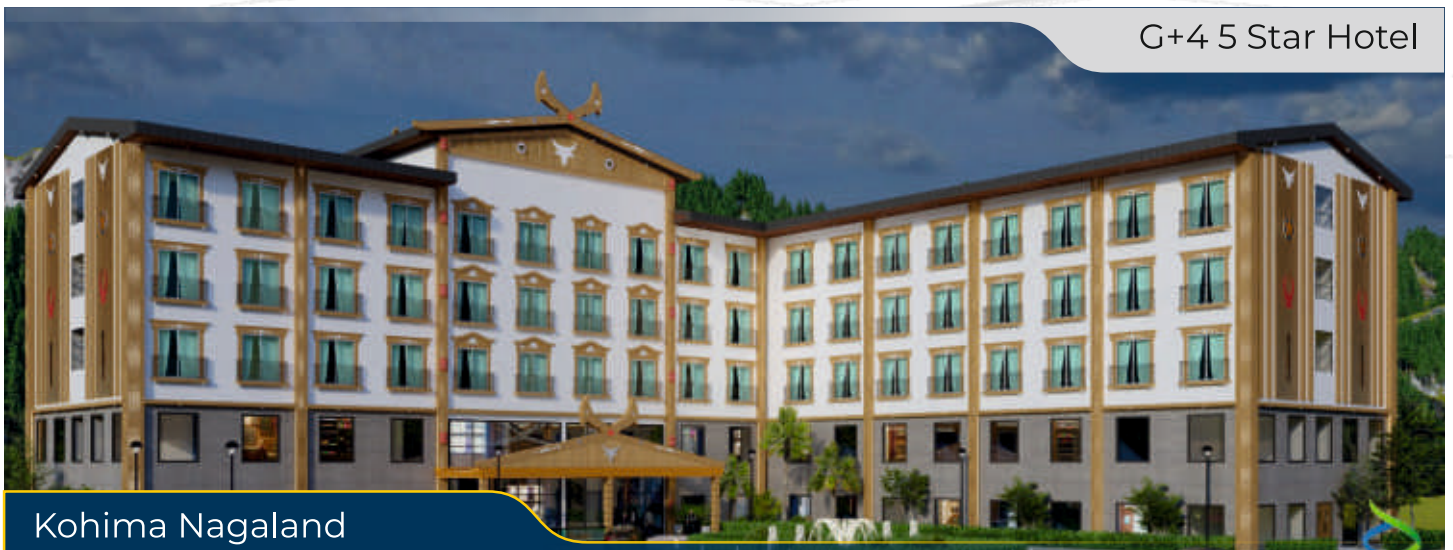

G+4 5 Star Hotel

Kohima Nagaland

GIS BUILDINGS



Scan to Watch Project Videos



Phagi, Rajasthan



Nepal



Thane, Maharashtra

INFRASTRUCTURES



Scan to Watch Project Videos

Area: 2.5 Lakh Sqft.



Hindon Airport

Area: 1.05 Lakh Sqft.



Darbhanga Airport

Area: 1.15 Lakh Sqft.



Chitrakoot Airport

Area: 1.11 Lakh Sqft.



Muirpur Airport

Area: 1.26 Lakh Sqft.



Sarsawa Airport



NSC Aircraft Hanger

HOSPITALS



Scan to Watch Project Videos



Area: 21,958 Sqft.

Imphal, Manipur



Area: 15,000 Sqft.

Sikandrabad, Uttar Pradesh

SPORTS & LEISURE



Scan to Watch Project Videos



Sports Stadium

Pokhara, Nepal



Squash Court

New Delhi



Cricket Stadium

New Delhi

MODULAR PREFABRICATED BUILDINGS



Scan to Watch Project Videos



Buxar, Bihar



Ramban, J&K



Bhutan



Mumbai, Maharashtra



Chambal , Rajasthan



Imphal, Manipur

SPECIAL STRUCTURES



Cold Storage Building



Agriculture Building



Covid Hospital

TESTIMONIALS



”
We're currently working with EPACK on two projects, and I'm really impressed with how open-minded and responsive they are. They listen to our questions, welcome new ideas, and act promptly. This is a great sign because, with each job, they're getting better and better. This not only benefits them but also the whole industry and everyone involved – the consultants and the owners. I wish them all the best!



CN SRINIVASAN
Managing Director, CR Narayan Rao & Associates

”
We are working with EPACK PREFAB, and we're really impressed. We visited their PEB manufacturing plants in both the north and south, and they have top-notch machinery. Personally, I'm interacting with Mr Sanjay Singhania and Jaideep Majumdar. They are very polite. EPACK PREFAB not only has a great PEB design team but also excellent manufacturing facilities. I wish the EPACK team all the best for their hard work.



YOGESH WAKE
Managing Director, Group Surya

”
I'm a lover of steel construction, and EPACK's been doing wonderful work. They've been doing wonderful work throughout the country. It's a wonderful experience. Thank you so much.



NILANJAN BASU
Managing Director, BCE Design Services LLP

”
I know EPACK PREFAB for the last three years, and I've seen them quickly become a big player in Pre Engineered Building (PEB) projects. Their growth in such a short time is quite impressive.



V SRIDHAR REDDY
Managing Director, Sri Harsha Consulting Engineers

”
I've been working with EPACK PREFAB since 2013, and we've recently completed some big projects together. EPACK is growing fast, and I believe they're on track to achieve great success. Best of luck for their future!



JIGAR SHAH
Director Divya Consutants

PARTICIPATIONS





LIFE AT EPACK



“Green Is Our Blueprint— Building Today For A Sustainable Tomorrow.”



LESS WASTE, MORE IMPACT

Precision manufacturing ensures optimized material use, reducing waste at every stage.



ENERGY SMART

Insulated panels and smart design lower energy consumption, making our buildings naturally efficient.



FASTER, CLEANER, GREENER

Prefabrication minimizes on-site disruptions, cuts emissions, and ensures a cleaner building process.



COMMITMENT TO A GREENER TOMORROW:

We continually invest in eco-friendly processes to shape a sustainable future in infrastructure.



54%

of our innovation is building a greener tomorrow, one sustainable structure at a time.

HSE POLICY

At EPACK PREFAB, a safe and secure workplace is of utmost importance. We emphasize safer processes and minimize effluent discharge potential. We are committed to the ideal of zero workplace injuries.

Below are the few measures taken by us to help improve the overall HSE concerns in the organization.

- We have a Safety Training Program to educate and to make our employees understand the importance of Health, Safety and Environment.
- We follow a strict PPE usage policy throughout all our Manufacturing Plants and Project Sites.
- Safe Operating Procedures for all machines and processes are strictly followed and are displayed throughout the shop-floor.
- Suggestion boxes are used by the employees to connect with the management regarding any concern regarding safety in their work area.
- We have an emergency preparedness plan for all emergencies that could arise in the plant and site.
- To monitor the health of our employees, We conduct health camp for employees time to time.
- We have certification of OSHAS 19001 for Health & Safety and IS 14001 for Environment .



35,470,629
Safe Man Hours

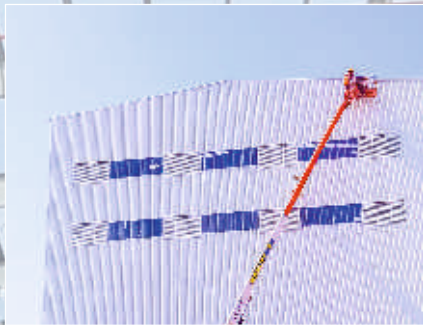

BUILDING YOUR VISION WITH PERFECTION

BRANCH OFFICES

HYDERABAD:- 101 A, Trendz Sapphire Building Hitech City
Hyderabad-500081 Telangana ,INDIA

CHENNAI:- 152, 2nd Floor Guleacha Tower Somasundara
Bharathi Nagar, Chennai, Tamilnadu 600026, INDIA

VIZAG:- PEELA'S Mindspace Level-4,2-36-2 MIG 7 M.V.P Colony
Sector-10 Visakhapatnam - 530017

AHMEDABAD:- 1013, One World West, Sardar Patel Ring Road,
Bopal, Ahmedabad Gujarat-380058,INDIA

BANGALORE:- AnthillIQ Workspaces, 44/2A, Kodigehalli gate,
Sahakarnagar post, Hebbal, Bangalore, Karnataka 560092

MANUFACTURING PLANTS / OFFICES

Unit-1&2 B 13 & 14 Ecotech-1st Extension Greater Noida-201306
Uttar Pradesh, INDIA

Unit-3 SP5/128, Ghiloth Industrial Area, Ghiloth-301705 Rajasthan-INDIA

Unit-4 Plot No- 5, APIIC Industrial Park, Mambattu (Near Sricity),
Tada Mandal Tirupati District-524401Andhra Pradesh, INDIA

Unit-4A Plot No- 6, APIIC Industrial Park, Mambattu (Near Sricity),
Tada Mandal Tirupati District-524401Andhra Pradesh, INDIA

SALES TEAM PRESENCE

Hyderabad, Vizag, Chennai, Mangalore, Kochi, Palakkad, New Delhi, Noida
Jaipur, Mumbai, Thane, Pune, Ahmedabad, Vadodara, Vapi, Surat, Indore
Kolkata, Bangalore, Jamshedpur, Patna, Coimbatore, Chandigarh, Guwahati
Bhubaneswar



Scan to Download
Technical & Product Brochure



Scan to Watch Project Videos



+91-81 304 44466



enquiry@epack.in



www.epack.in